



## Lenticular Filter Housings

Lenticular Filter Housings are depth housings for Lenticular filters. They can replace DE filter to remove the particles in kinds of liquids for filtration, clarification and purification. The housings are constructed under sanitary grade standards with high precision polishing. There is no residual liquid after using and easy to clean. With the bottom inlet and outlet design, it can avoid the turbulence of liquid effectively and improve the filtration performance. The housing can hold maximum 4 pcs lenticular filters and meet the high flow requirement

## APPLICATIONS

- The particle filtration of wine, beer, syrup
- The prefiltration of juice
- The final filtration of juice
- The clarification of wine, liquid gel, olive oil
- The liquid filtration in pharmaceutical, chemical, microelectronics industry

## BENEFITS

- High flow rate, less space needed, high efficiency.
- SS 304 and SS 316L material with good corrosion resistance for many different applications
- Stand type and horizontal type for choosing

## PRODUCT SPECIFICATIONS

### Material of constructions

Housing body : SS304, SS316L

### Vent/Drain

SS304, 3SS16L

### Eyebolt

SS304

### O-mng/Gasket

EPDM, PTFE, Viton, Silicone

## CONNECTIONS

### Body connection

Flange

### Inlet/ outlet N1、 N2

Quick Install, Thread

### Pressure gage N3 (optional)

1.5" Quick Install

### Drain N4 (optional)

1" Quick Install

### Vent N5 (optional)

1/2 "Quick Install

## SURFACE POLISHING

### Polishing Type

Mechanical polishing, Electrolytic polishing

### Polishing Precision

Inside 0.3um, Outside 0. 4um

## PERFORMANCE

### Max Operation pressure

0.6MPa

### Max Operation temperature

150°C

### Sterilization

SIP or steam, 121°C/30min

Dimensions	12"Depth-stack Cartridge				16"Depth-stack Cartridge			
	1PC	2PC	3PC	4PC	1PC	2PC	3PC	4PC
A:Total height (except pressure gage)	950	1210	1490	1760	960	1230	1500	1770
B:Inlet center distance	200				250			
C:Diameter	Ø325				Ø450			
D:Terrain clearance of inlet/outlet N1. N2	280				280			
Inlet/outlet N1, N2	2"				2"			

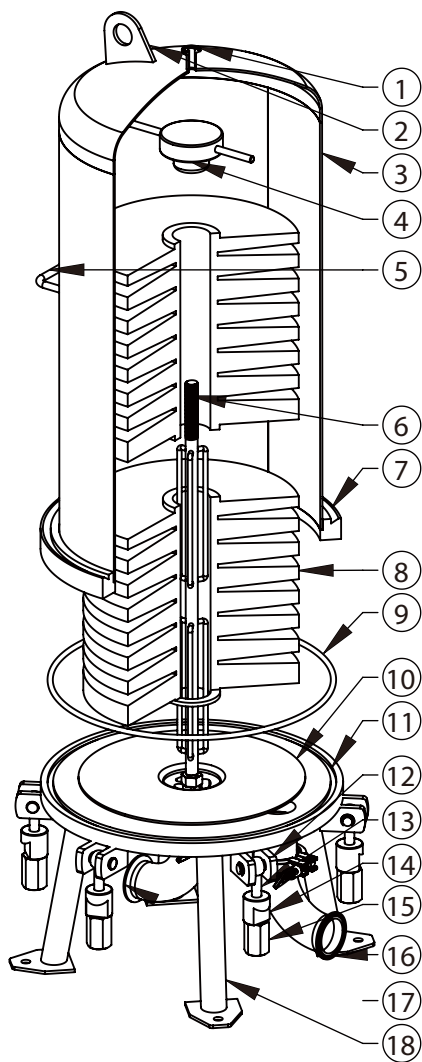

No.	Description
1	Vent
2	Lifting lug
3	Shell
4	Nut
5	Handle
6	Threaded rod
7	Shell Flange
8	Filter cartridge
9	O-ring
10	Support plate
11	Base
12	Eye bolt socket
13	Eye bolt
14	Padlock
15	Nut
16	Port Inlet
17	Port Outlet
18	Support leg

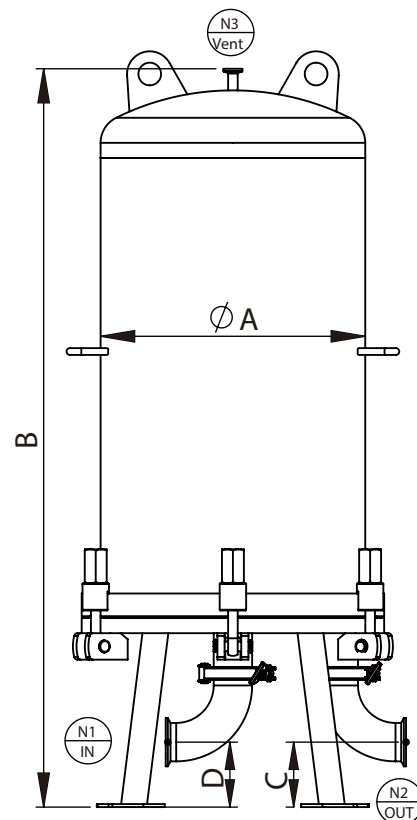
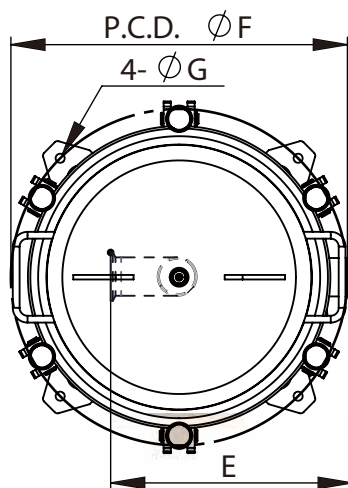

## ORDERING CODE

Example : MHHLF-2C-16-F-6-E

	Cartridge Qty	Cartridge Diameter	Inlet/outlet Connection	Body Material	Seal Material
<b>HMHLF</b> <div style="display: flex; align-items: center;"> <div style="width: 10px; height: 10px; background-color: blue; margin-right: 5px;"></div> <div style="margin-right: 5px;">-</div> </div>	1C = 1 pcs 2C = 2 pcs 3C = 3 pcs 4C = 4 pcs	12 = 12" 16 = 16"	F = Flange K = Quick Install L = Thread	<div style="display: flex; align-items: center;"> <div style="width: 10px; height: 10px; background-color: blue; margin-right: 5px;"></div> <div style="margin-right: 5px;">-</div> </div>	E = EPDM P = PTFE V = Viton S = Silicone